

THIS DRAWING IS UNPUBLISHED  
 RELEASED FOR PUBLICATION AUG ,2006.  
 ALL RIGHTS RESERVED.  
 © COPYRIGHT 2006 By - TE CONNECTIVITY

REVISIONS					
P	LTR	DESCRIPTION	DATE	DWN	APVD
	A2	DES IN ZONE B2 UPDATED FROM W/O TO W/	09FEB2017	RP	PS

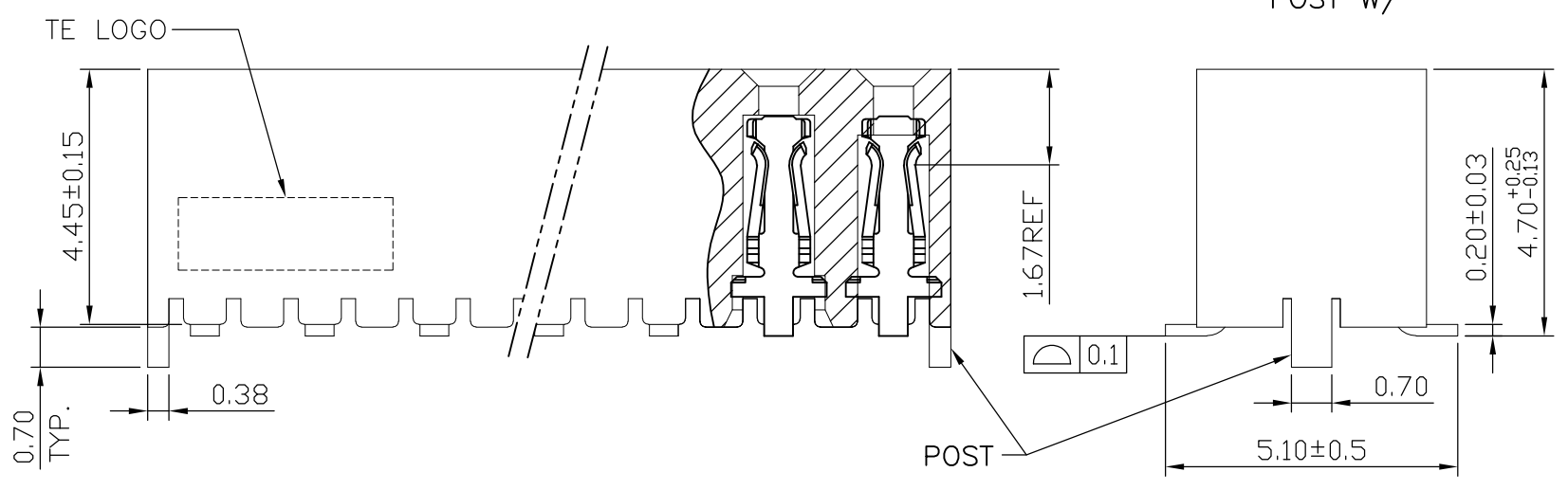
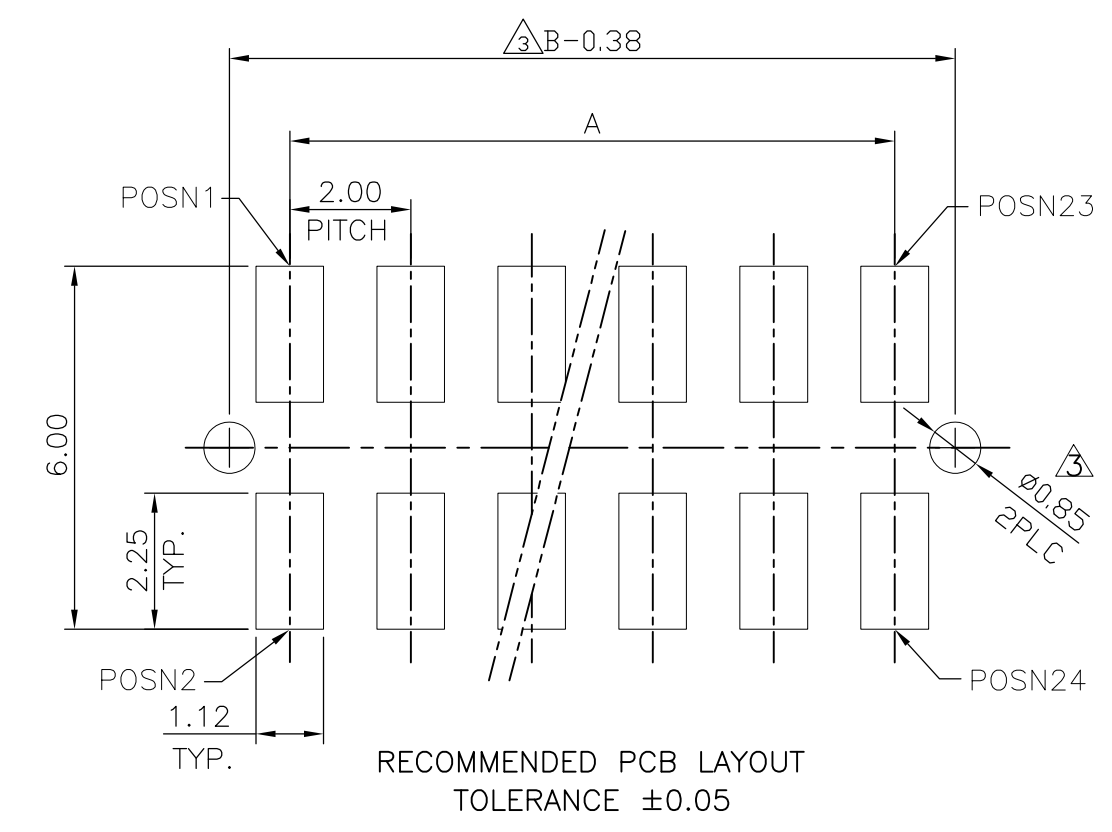
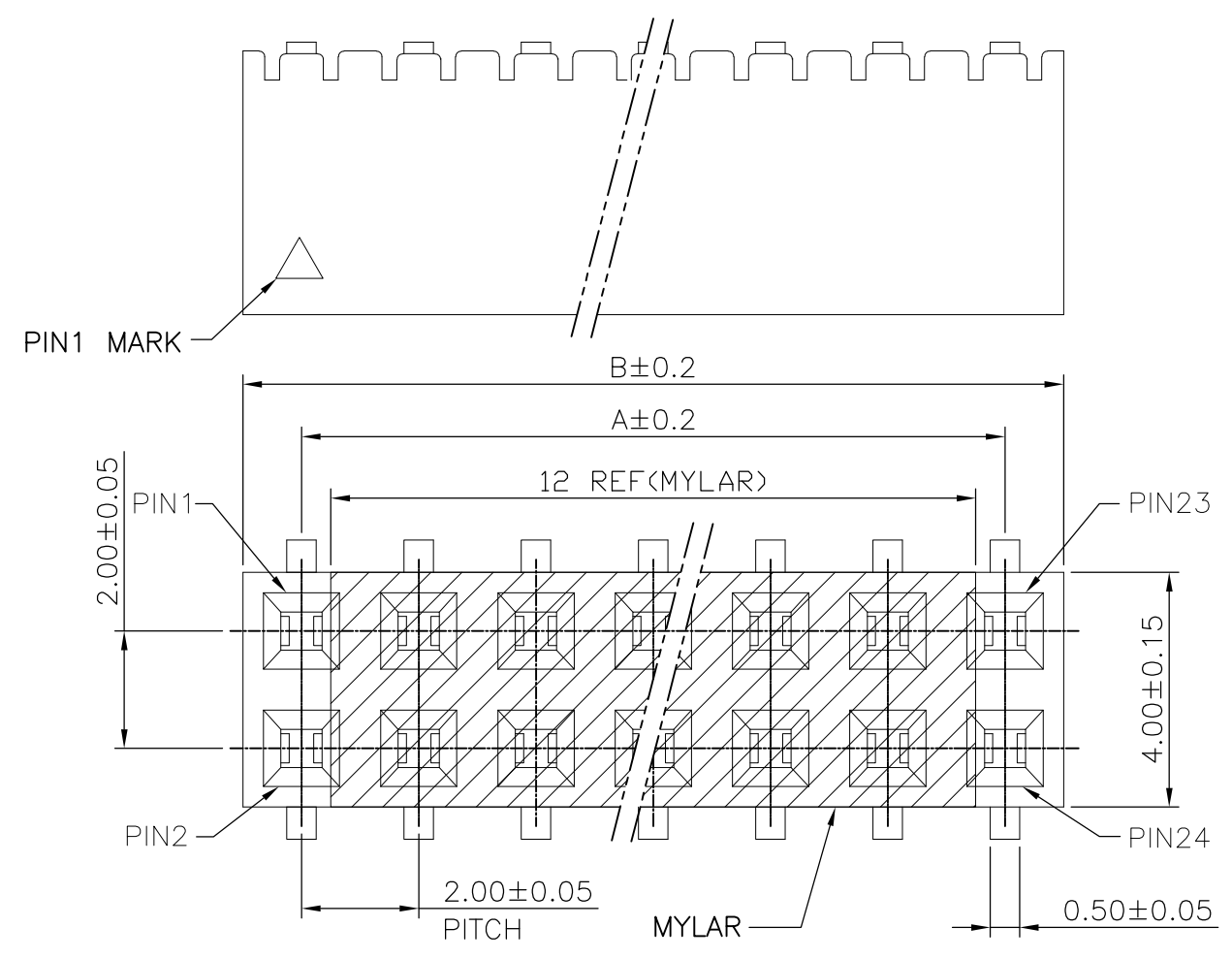

- NOTE:
- 1 MATERIAL: HOUSING: LCP GF30%, UL 94V-0 ,COLOR: BLACK.  
CONTACT: PHOSPHOR BRONZE  
MYLAR: POLYIMIDE FILM
  - 2 FINISH: Au 0.762µm [30µ"] MIN. AT THE CONTACT AREA.  
MATTE Tin 2.54µm [100µ"] MIN. AT THE SOLDER TAIL AREA.  
Ni 1.27µm [50µ"] MIN. UNDER PLATED ALL OVER.
  - 3 POST APPLY PN USED
  - 4. REFLOW SOLDER CAPABLE TO 260°C PER TE TEST SPEC.  
109-201, CONDITION B.
  - 5. QUALIFICATION TEST REPORT: 501-57197

OBSOLETE	W/O	24	22	24	7-2041069-4
	W/	24	22	24	2-2041069-4
	POST	B	A	POS	PART NUMBER

THIS DRAWING IS A CONTROLLED DOCUMENT.		DWN O.HU 18AUG2006	TE Connectivity AMPMODU 2.00mm PITCH, DUAL ROW, REC., SURFACE MOUNT		
DIMENSIONS: mm		CHK S.HOU 18AUG2006			
TOLERANCES UNLESS OTHERWISE SPECIFIED:		APVD W.J.KE 18AUG2006			
0 PLC ± - 1 PLC ± 0.3 2 PLC ± 0.2 3 PLC ± - 4 PLC ± - ANGLES ± 3° FINISH		NAME 108-57707			
MATERIAL 1		PRODUCT SPEC 108-57707	SIZE A3	CAGE CODE 00779	DRAWING NO C-2041069
		APPLICATION SPEC -	RESTRICTED TO -	SCALE 1:1	SHEET 1 OF 2
		WEIGHT	CUSTOMER DRAWING	REV A2	

4

3

2

1

THIS DRAWING IS UNPUBLISHED  
 © COPYRIGHT 2006 By - TE CONNECTIVITY  
 RELEASED FOR PUBLICATION  
 ALL RIGHTS RESERVED.  
 AUG , 2006.

REVISIONS					
P	LTR	DESCRIPTION	DATE	DWN	APVD
-	-	SEE SHEET 1	-	-	-

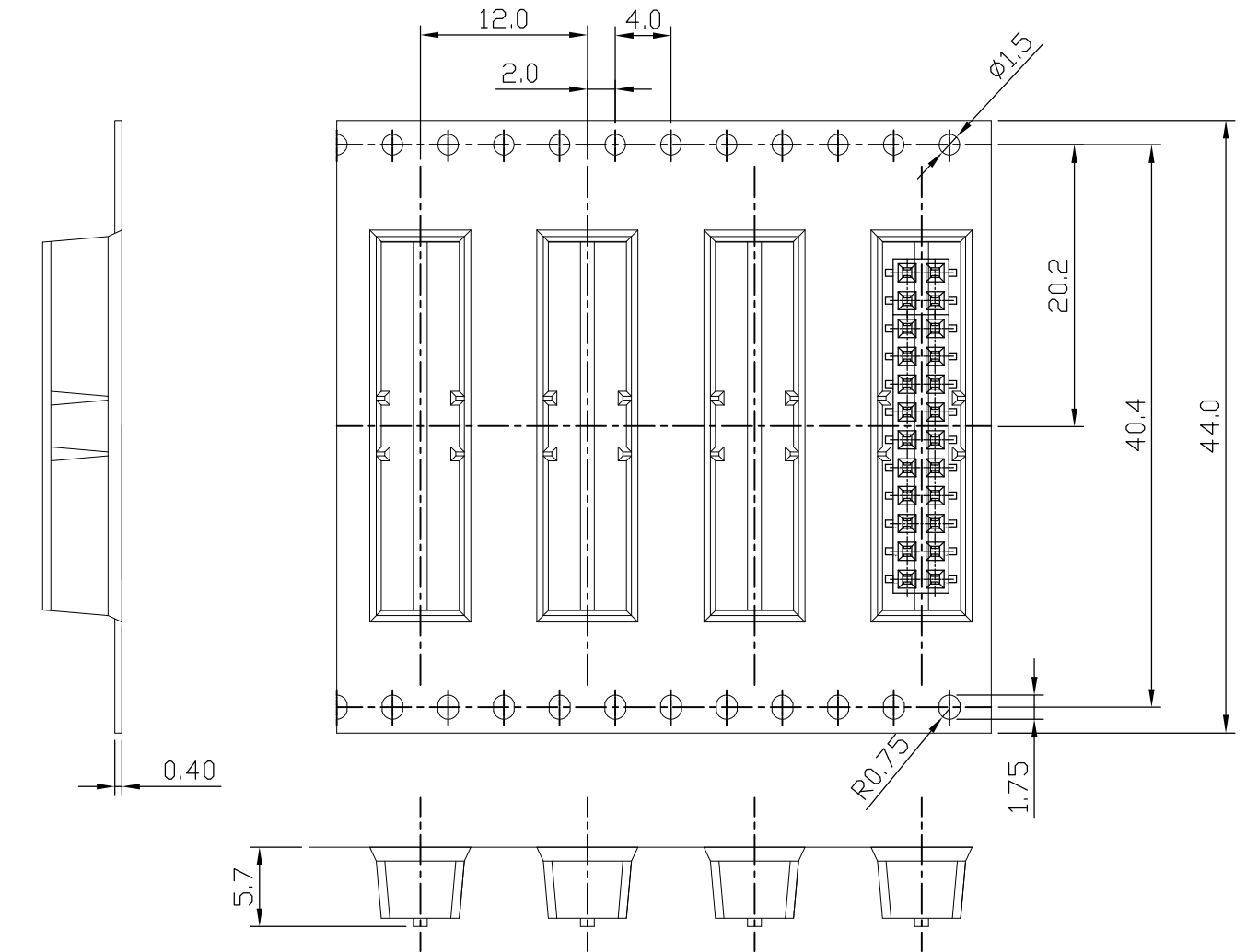
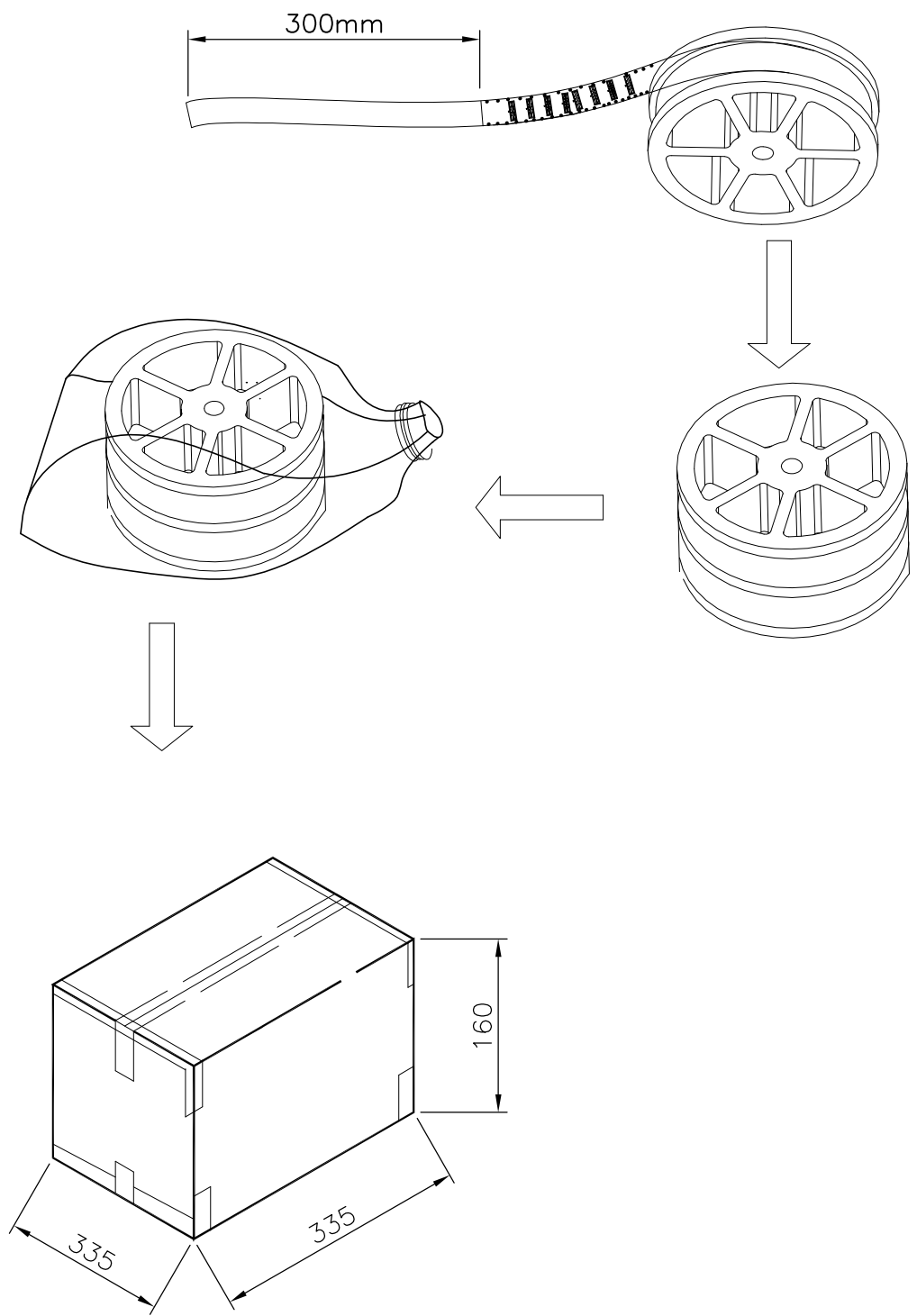

900	3	2700	3.6	1.9
PCS/REEL	REELS/SHIPPING BOX	QUANTITY (PCS)	G/W (kg)	N/W (kg)

THIS DRAWING IS A CONTROLLED DOCUMENT.		DWN	18AUG2006		
		CHK	18AUG2006		
		APVD	18AUG2006		
		NAME	AMPMODU 2.00mm PITCH, DUAL ROW, REC., SURFACE MOUNT		
		PRODUCT SPEC	108-57707		
		APPLICATION SPEC	-		
		WEIGHT	-		
MATERIAL		FINISH	SIZE	CAGE CODE	DRAWING NO
SEE SHEET 1		SEE SHEET 1	A3	00779	C-2041069
		CUSTOMER DRAWING	SCALE	SHEET	REV
			1:1	2 OF 2	A2

